

# Fork positioner

**RZV-IG  
ISO IV**

integrated, integral sideshift, bolt-on forks

**The fork positioner RZV-IG** with bolt-on forks has stable round bar guides in which the two mounting plates with forks are moved. Sideshift by valve allows sideshift depending on the opening range of the fork mounts. Standard ISO 2328 forks can also be used and the fork length can be up to 2400 mm. Very good visibility is to be emphasized which makes safe working possible. Euro pallets can be picked up lengthwise. In addition, this device is characterised by its compact design whereby the forklift retains the greatest possible residual load capacity.

Delivery incl. brackets, stubshafts and chain anchors.

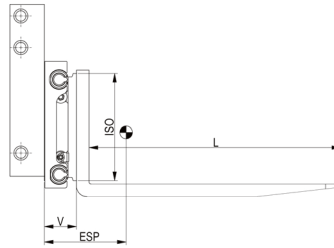
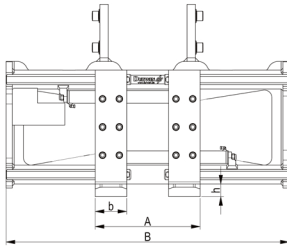

type	capacity kg LC mm	lift truck to LC mm	ISO	B mm	A mm	forks b x h x L mm	V LLC mm	ESP COG mm	weight kg
RZV 50-IG	5000/600	5,0/600	IV	1350 1450 1550	500-1440 500-1540 500-1640	150x70x1200	163	295 290 285	600 615 630
RZV 60-IG	6000/600	6,0/600		1460 1860	560-1560 560-1960	150x70x1200	165	240 225	710 770
RZV 70-IG	7000/600	6,5-7,0/600		1460 1860 2060	560-1560 560-1960 560-2160	150x70x1200	165	235 220 215	720 780 820
RZV 80-IG	8000/600	8,0/600		1460 1800 1860 2060 2160 2260 2400	560-1560 560-1900 560-1960 560-2160 560-2260 560-2360 560-2500	200x70x1200	165	270 245 240 235 233 225 220	830 885 895 930 948 965 995
RZV 100-IG	8000/900	8,0/900		2060 2160 2260 2400	560-2160 560-2260 560-2360 560-2500	200x80x1200	190	240 238 235 230	1135 1160 1185 1230
RZV 110-IG	8000/1100	8,0/1100		2060 2260 2400	560-2160 560-2360 560-2500	200x80x1200	192	243 238 233	1150 1200 1245

- 2 hydraulic functions required
- without hoses and couplings
- features bolt-on forks as standard
- sideshift via valve, depending on opening range
- for hook-on forks ISO 2328
- including brackets, chain anchor and stub shafts, without rollers

- detailed information including carriage drawings are required with the order as well as fork lift model and mast model details
- weight, COG and LLC do not include brackets
- LLC does not include forks
- protection strip/load backrest see page 240
- for forks up to 2400 mm, longer please ask
- clamping of goods is not allowed

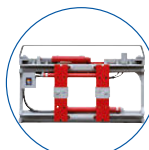
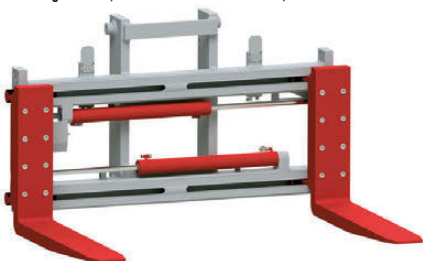

option: protection strip

**DURWEN**   
Forklift Attachments

More than 75 years experience